

**PARKING DETAIL**  
NO SCALE

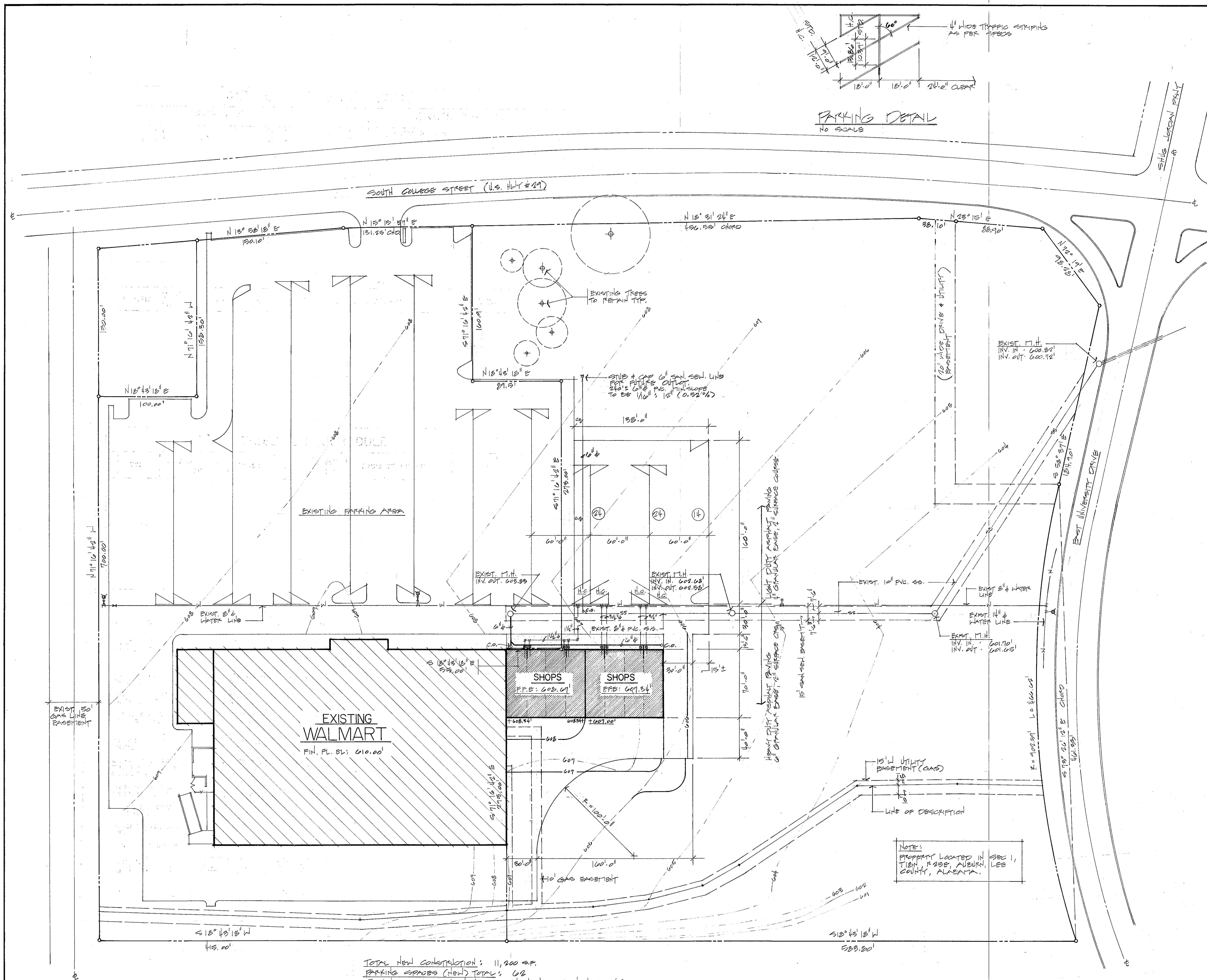

TOTAL NEW CONSTRUCTION: 11,200 SF.  
 PARKING SPACES (NEW) TOTAL: 62  
 PARKING RATIO: 5.54 / MSP (NEW SHOPS VS. NEW PARKING)

NOTE:  
 PROPERTY LOCATED IN SEC 1,  
 T15N R25E, ALBURN  
 COUNTY, ALABAMA.

**SITE UTILITY / GRADING PLAN**  
SCALE: 1" = 40'-0"

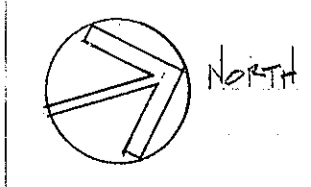

**ROBERTSON LOIA P.C.**  
ATLANTA, GEORGIA

ARCHITECTURE  
ENGINEERING  
PLANNING



REVISIONS  
 #1 ADD SAN. SEW. TO  
 OUTLOT 7.18.85

PROJECT  
**NEW SHOPS  
 ADDITION**  
 ALBURN, ALABAMA

SHEET TITLE  
**SITE PLAN**

DATE 6.14.85  
 JOB NUMBER 85.144

SHEET NUMBER  
**C-1**

OF 1